



Series 2601

**Zetco AGA Approved
Cast Iron Flanged
Ball Valve 200mm**

DESCRIPTION

A flanged cast iron ball valve AGA approved to AS 4617 (Approval #6633 Type 1 - Isolation Valve). Double stem o-rings provide dynamic sealing to prevent leakage and carbon-reinforced PTFE ball seals ensure smooth reliable operation. Suitable for a range of applications, the full and straight bore minimises head loss and reduces turbulence during operation.

FEATURES

Design	<p>Investment cast body and flange in cast iron</p> <p>Epoxy coating prevents corrosion, tuberculation and surface wear while promoting efficient flow of fluids</p> <p>Reinforced PTFE ball seals for consistent operating torque</p> <p>Lockable lever handle for added safety and security</p> <p>Blow-out proof stem to prevent leakage</p>
Production	<p>Manufactured in Italy under ISO 9001 Quality Management System</p> <p>All valves are pressure tested during production</p>
Technical	<p>Flanges drilled to ANSI B16.5 150 or AS 2129 Table D/E</p> <p>Flow capacity: Full bore</p> <p>Flow control: On/off only, not intended for throttling</p> <p>Temperature range: -20°C to 70°C</p> <p>Max. pressure: 1600 kPa (refer to graph)</p> <p>NOTE: Not suitable for buried installations</p>
Options & Variants	<p>Size: DN200 (8")</p> <p>Series 2601 AGA approved ductile iron flanged ball valve</p> <p>Series 2602 AGA approved ductile iron flanged underground ball valve</p> <p>Series 2603 AGA approved ductile iron flanged lockable ball valve</p> <p>Series 2607 WaterMarked bronze flanged ball valve lockable</p>



AGA 6633 G
AS 4617

Series 2601

Zetco AGA Approved Cast Iron Flanged
Ball Valve 200mm



DESCRIPTION

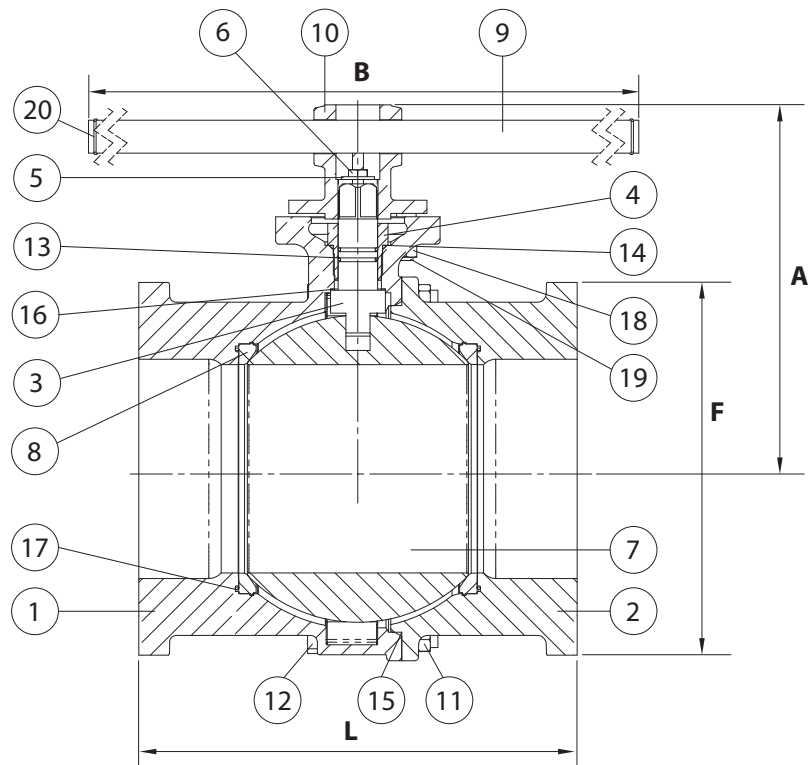

PARTS MATERIALS

POS.	PART	MATERIAL
1	BODY	CAST IRON
2	FLANGE	CAST IRON
3	STEM	BRASS
4	GLAND NUT	BRASS
5	WASHER	STAINLESS STEEL 304
6	BOLT	STAINLESS STEEL 304
7	BALL	CAST IRON (CHROME PLATED)
8	SEAL	PTFE + CARBON
9	LEVER	ZINC PLATED STEEL
10	LEVER HUB	DUCTILE IRON
11	NUT	STAINLESS STEEL 304
12	BOLT	STAINLESS STEEL 304
13	O-RING	NBR
14	O-RING	NBR
15	O-RING	NBR
16	THRUST WASHER	PTFE
17	O-RING	NBR
18	LEVER STOP NUT	STAINLESS STEEL 304
19	LEVER STOP BOLT	STAINLESS STEEL 304
20	O-RING	NBR

DIMENSIONS (mm)

Prod. Code	Size	A	B	L	F	Kv	Wgt Kg
2601200	200	332	1000	392	340	5957	93.00

PRESSURE/TEMPERATURE GRAPH

